

Finishing Your Quilt from Quilt Design NW

Layering and quilting

- Mark quilting design on the quilt top as desired. Quilting suggestions: Stitch-in-the ditch around the block patches and close to the sashing and borders. Cross-hatch borders.
- Prepare the backing fabric and batting so they are at least four inches larger than the quilt top.
- Position the backing face down on a table or floor.
- Pull the backing taut and tape to table or floor.
- Place the batting on top of the backing then layer the quilt top, face up and centered, on top of the batting.
- Baste all the layers together using thread or safety pins.
- Quilt or tie.
- When the quilting is complete remove the basting threads or pins, and trim the backing and batting so they are the same size as the quilt top.

Binding

- Cut the binding fabric into 2 1/4" strips, across the width of the fabric, from selvedge to selvedge. Trim each end of the strips at a 45° angle as shown. 
- Sew the individual strips together into one strip long enough to go around the entire quilt. Fold the binding in half—raw edges together—to create a long, narrow, folded binding strip.
- Starting at about the center of one side of the quilt, lay the binding strip along the top of the quilt. Starting with a backstitch at about 5" from the angled end of the binding, sew the binding to the quilt, using 1/4" seam, until you are 1/4" from the edge of the quilt.

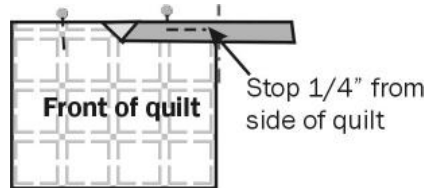

- Backstitch, cut threads and remove from machine.
- To turn the corner, fold the binding straight up creating a 45 degree angle as shown in diagram.

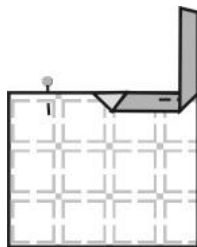

- Bring the binding straight down so the fold is aligned with the top raw edge of the quilt. Start stitching at the edge of the quilt. Go forward a couple of stitches, backstitch two stitches, then stitch the length of the side until you are 1/4" from the next edge of the quilt.
- Repeat the corner process.
- Repeat for all sides of the quilt.

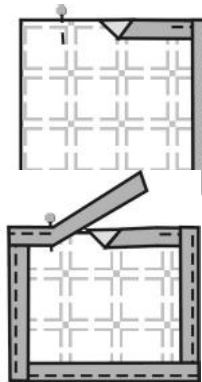

- When you reach a point about 10" from where you started stitching, backstitch and remove the quilt from the machine.
- Pull both ends of excess binding straight across the quilt as shown in diagram below. Mark the position of the start of the binding on the tail with a pin or pencil line. This pin or line will be at a 45° angle.

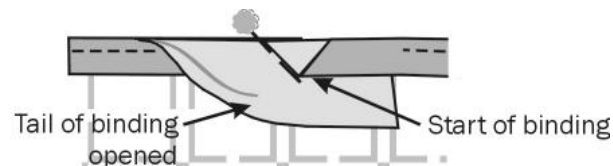

- Without removing the pin, trim the tail 1/2" beyond the pin (away from the pin **towards** the excess tail end of binding) at a 45° angle, parallel to the pin.

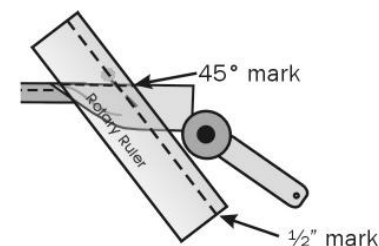

- Unfold the starting portion of the binding and sew the two ends together to create a continuous strip of binding. Press seam open.
- Refold the binding and place it on top of the quilt. Complete sewing the binding to the quilt
- Turn the edge of the binding to the back side of the quilt and blind-stitch in place by hand, folding in the excess at the corners to create mitered corners.